

frost-trol
SOLID LINES



PLUG-IN

MICHIGAN

Semimural



MICHIGAN

PM00|25|16|61|BD|20

Highlights

This model includes energy efficient fans in both the evaporator and condenser.

Ideal for the exhibition of promotional products or "Grab&Go".

Eco-efficient model, adapted to current regulations on the use of refrigerants to reduce the impact of emissions to the atmosphere.

Wide load capacity and optimal display of exposed products.



PLUG-IN

Standard equipment

R290 refrigerant

Condensate evaporation tray

Front glass riser (ND cabinets)

Mechanical fans

Electronic control

White pre-lacquered tank

4000K Superior Compact LED Lighting

Full Vision dual sliding doors (SD version)

Natural defrost

Night curtain included (in ND version)

40mm scanner price tag in tank

Fan protection

RAL 9001

RAL 9010

RAL 7305

RAL 9006

RAL 1018

RAL 1023

RAL 5000

RAL 5012

RAL 6018

RAL 6027

RAL 3027

RAL 3002

RAL 9005

RAL 9011

STANDARD COLOURS

Options and Accessories

- LED lighting
 - Integrated LED lighting on canopy
 - Integrated LED lighting on shelves
 - Basic LED lighting on canopy and shelves
- Pre-lacquered components:
 - Shelves
 - Trays
 - Fairings
- Components in stainless steel AISI-304:
 - Suction
 - Shelves
 - Trays
 - Fairings
- Reinforced shelves painted in Epoxy or Stainless Steel AISI-304
- Options in stainless steel AISI-304:
 - Internal deposit
 - Kit plate and fan cover/evaporator cover/air brake
- Separators:
 - Methacrylate fixed
 - For shelves (methacrylate/grid)
 - For tray (methacrylate/grid)
- Stainless steel bumper
- Electric defrost
- EC fans
- Top strip painted, painted for TTC, AISI-304 stainless steel, AISI-304 stainless steel for TTC and glass
- Priceholder on shelf
- 40mm methacrylate product stopper for shelves



INTEGRATED LED LIGHTING



FRAME DOORS

NO DOORS

PM0000166157ND17

Available modulations
1250 | 1875 | 2500

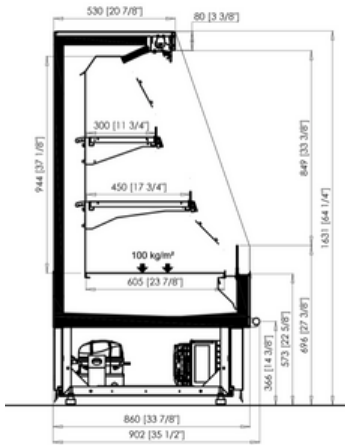

CON PUERTAS

PM0000166157SD17

Available modulations
1250 | 1875 | 2500

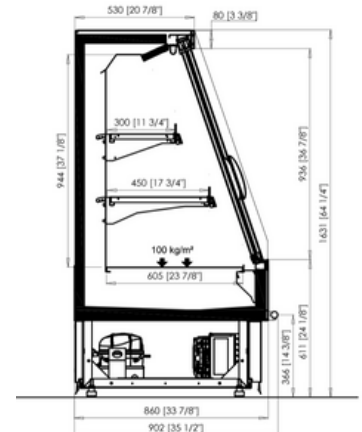

NO DOORS

PM0000186157ND17

Available modulations
1250 | 1875 | 2500

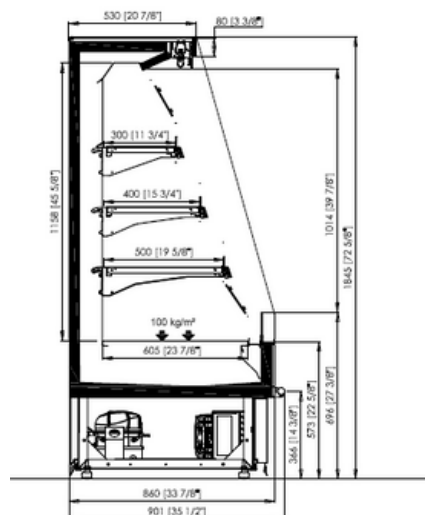

WITH DOORS

PM0000186157SD17

Available modulations
1250 | 1875 | 2500

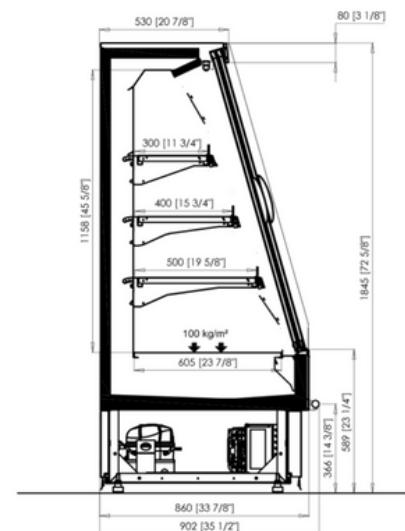

frost-trol



www.frost-trol.com



FROST-TROL, S.A
PLANTA 1
CV 159 KM 2 CP. 12180
Cabanes (Castellón) España
+34 964 34 27 40

FROST-TROL, S.A
PLANTA 2
AVDA. DEL CASTELL VELL, 188
12180
Castellón - España
+34 964 34 27 40

FROST-TROL, S.A
MÉXICO
AV. PIRULES, 134 B ESQUINA CON AV.
TEJOCOTES - 54769
Cuautitlán Izcalli - Estado de México
+34 964 34 27 40

FROST-TROL, S.A
FRANCIA
BUREAU B09 RUE LE BOUVIER
92340 - BOURG LA REINE
(PARIS) FRANCE

FROST-TROL, S.A
DUBAI
GOLDCREST EXECUTIVE
JUMERIAH LAKES TOWERS
(DUBAI) EMIRATOS ÁRABES
UNIDOS

