

frost-trol
SOLID LINES



SUPERMARKET

ALBORNES

Rear Service Cabinet



ALBORNES

HMRO|18|22|61|86|SD|17



SUPERMARKET

Highlights

Specially designed as an auxiliary cabinet in shops specialized in the sale of meat products and deli.

Expand its load capacity thanks to the extra reserve area.

This model is offered in plug-in version (Bolmen).

Standard equipment

Independent under storage (refrigerated or not refrigerated)

EC fans

Ventilated cooling system

Standard HFC evaporator

Thermostatic valve

Natural defrost

Electronic control

Bottom set in RAL 7015 color

White pre-laquered tank

40 mm scanner price tag in tank

Fan protection

Integrated 4000K LED simple top lighting

RAL 9001

RAL 9010

RAL 7305

RAL 9006

RAL 1018

RAL 1023

RAL 5000

RAL 5012

RAL 6018

RAL 6027

RAL 3027

RAL 3002

RAL 9005

RAL 9011

STANDARD COLOURS

Options and Accessories

- Optimized evaporators for CO2 and Glycol
- Electronic expansion valve
- LED lighting:
 - Top LED (single/double)
 - Shelves
 - Doors
- Doors:
 - Swinging
 - Sliding
 - Full Vision
 - Full Vision Plus
- Gable ends:
 - Panoramic gable ends
 - Mirror Opaque (piece of glass)
 - Opaque (sheet)
 - Intermediate
- Separators:
 - Product rod separator
 - Product plexiglass separator
 - Vertical separator
- Night curtain:
 - Hydraulic brake
 - Motorized*
- Stainless steel AISI-304 options:
 - Fairings and suction grids/display deck/shelves
 - Internal deposit
 - Kit plate and fan cover/evaporator cover/air brake
- Defrost:
 - Electric
 - Hot gas
- Display elements:
 - Total Tactile Control
 - Top mirror
 - Stainless bumper
 - Plexiglass front shelves
 - Plexiglass front riser
 - Grids fund
 - Ventilated front panel
 - Reinforced shelves
 - Scanner price tag in shelf
 - Hooks bar (single/double)



UNDER STORAGE (REFRIGERATED OR NON REFRIGERATED)



ALBORNES ST/ND (NO DOORS)

HMR000226186ND17

Available modulations
1250 | 1875 | 2500 | 3750

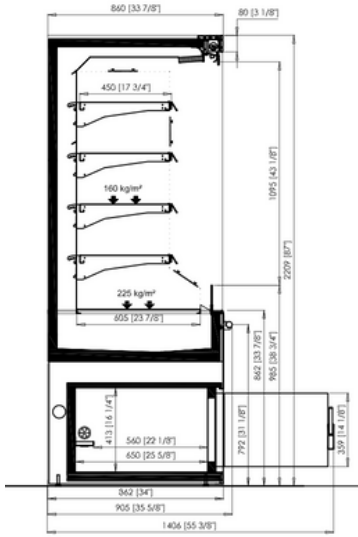

ALBORNES ST/SD (WITH DOORS)

HMR000226186SD17

Available modulations
1250 | 1875 | 2500 | 3750

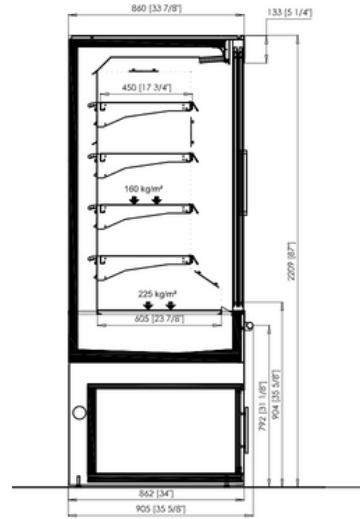

SLIDING
FRAME DOORS

frost-trol



www.frost-trol.com



FROST-TROL, S.A
PLANTA 1
CV 159 KM 2 CP. 12180
Cabanes (Castellón) España
+34 964 34 27 40

FROST-TROL, S.A
PLANTA 2
AVDA. DEL CASTELL VELL, 188
12180
CASTELLÓN - ESPAÑA
+34 964 34 27 40

FROST-TROL, S.A
MÉXICO
AV. PIRULES, 134 B ESQUINA CON AV.
TEJOCOTES - 54769
CUAUTITLÁN IZCALLI - ESTADO DE
MÉXICO

FROST-TROL, S.A
FRANCIA
BUREAU B09 RUE LE BOUVIER
92340 - BOURG LA REINE
(PARIS) FRANCE

FROST-TROL, S.A
DUBAI
GOLDCREST EXECUTIVE
JUMERIAH LAKES TOWERS
(DUBAI) EMIRATOS ÁRABES
UNIDOS

